



ASSE PROFESSIONAL DEVELOPMENT CONFERENCE & EXPOSITION
JUNE 12 – 15 | CHICAGO, ILLINOIS
www.SAFETY2011.org

Pocket Planner Your Personal Schedule



ALL EVENTS WILL BE HELD AT MCCORMICK PLACE WEST
UNLESS OTHERWISE INDICATED.

SUNDAY, JUNE 12

10:00AM-5:30PM	Safety 2011 Conference Registration Open	Level 3
	Service Center	Level 3
	Cyber Center	Level 3 and Level 1 by 179 B and 190 B
11:00AM-3:00PM	NexSteps Career Center	Level 4, Room 475 A
12:00PM-3:30PM	House of Delegates/Membership Meeting	Level 1, Room 196
3:00PM-5:30PM	Kick-off Welcoming Reception/ Exposition Open	Exhibit Hall F1

MONDAY, JUNE 13

6:30AM-4:45PM	Safety 2011 Conference Registration Open	Level 3
7:30AM-9:15AM	Opening General Session	Level 3, Skyline Ballroom
9:00AM-4:15PM	Exposition Open	Exhibit Hall F1
9:15AM-10:45AM	Exposition Exclusive Time	Exhibit Hall F1
9:30AM-10:30AM	New Attendee Orientation	Level 1, Room 187
10:45AM-11:45AM	Concurrent Education Sessions, Period I	Levels 1 & 2

Session No.	Session Title	Room
□ 501	Social Media, Smart Phones, and e-Learning for Safety and Health Professionals	196 C
□ 502	Volunteer Leadership: Motivating Members into Action	179 B
□ 503	Building LIFE: How to Get Craft Truly Engaged in Construction Projects	178 B
□ 504	Corporate Social Responsibility: How Can You Add Value as a SH&E Professional?	196 B
□ 505	Childbearing-Aged Women's Exposures to Multiple Environmental Chemicals	176 A
□ 506	Sustaining and Leveraging High Impact Ergonomic Improvements	180
□ 507	Fire Pre-Incident Planning: Understanding if There is a Problem	184 D
□ 508	Industrial Hygiene Evaluation and Sampling for the Safety Professional	194 A/B
□ 509	The Triangle Shirtwaist Factory Fire	190 B
□ 510	Human Error Elimination: Keeping Your Head in the Game	181
□ 511	CSIRO Striving for Zero Harm in a Diverse Work Environment	175 C
□ 512	Getting the Best Out of Collateral Safety Representatives in the Public Sector	176 C
□ 513	OSHA Current Activities Update	190 A
□ 514	Predictive Analytics: A Scientific Leading Indicator	186

Continued on next page.

10:45AM-11:45AM	Concurrent Education Sessions, Period I (Continued)	Levels 1 & 2
□ 515	A Severity Study in Reverse: Testing Heinrich's Safety Pyramid	196 A
□ 516	Six Safety Leadership: Energizing & Sustaining Safety Momentum	192 A-C
□ 517	Identifying Cultural Hazards: Four Clues That You May Be Out of Balance	183 C
□ 518	What Have We Learned from the BP Catastrophe?	184 B/C
□ 519	Proactive Safety Professionals Create Successful Fall Protection Solutions	184 A
□ 520	Machine Safety: New and Updated Consensus Standards... What You Need to Know	178 A
□ 521	Successful Training and Its Essential Elements via Case Stories!	193
□ 522	Do You Really Know What's Going On in Your Fleet?	179 A
□ 523	Expo Education: Safety Eyewear & ANSI Standards: Seeing is Believing!	175 B
□ 524	Fundamentals of SH&E: Overview of Regulatory Compliance 101A	175 A
□ 525	Key Issue Roundtable #1: Using the Internet for Marketing	176 B
11:45AM-1:10PM	Complimentary Conference Luncheon & Program	Level 3, Skyline Ballroom
1:15PM-2:00PM	Exposition Exclusive Time	Exhibit Hall F1
2:00PM-3:00PM	Plenary Session, Occupational Safety & Health	Level 3, Skyline Ballroom
3:00PM-4:15PM	Exposition Exclusive Time	Exhibit Hall F1
4:15PM-5:15PM	Concurrent Education Sessions, Period II	Levels 1 & 2
□ 551	The Zen of the Business-Aligned Safety Program	196 A
□ 552	Practicing Diversity in the Workplace to Achieve Organization Goals	176 A
□ 553	OSHA Construction-Cranes, Confined Space, Data, Residential, Steel Erection, etc.	190 B
□ 554	PCBs in Building Materials and the Implications for the Construction Industry	175 C
□ 555	Emergency Preparedness in the Workplace	194 A/B
□ 556	Environmental Compliance for the Safety Manager	196 B
□ 557	Ergonomics for Telecommuters and Other Remote Workers	193
□ 558	Aging Workforce: Occupational Safety, Health, Hygiene and Wellness Considerations	190 A
□ 559	Mayo Clinic's Approach to an Integrated Safety Program	176 C

□ 560	People-Powered Safety: Oldies but Goodies from Dr. G.	192 A-C
□ 561	Lessons from China: ASSE's 2010 Delegation to Shanghai and Beijing	178 A
□ 562	School Safety: The Charter School Challenge	179 B
□ 563	OSHA Challenge: A Road Map to Safety and Health Excellence	186
□ 564	Maximizing Your Insurance Risk Control Consultation Relationship: Construction	175 A
□ 565	100 Years of Workers' Compensation	184 D
□ 566	Hiring With Safety in Mind: Risk Takers Need Not Apply	179 A
□ 567	Climate vs. Culture	181
□ 568	Driving Operational Discipline Through Quality Written Procedures	183 C
□ 569	How New Z359 Standards Influence a Maturing Fall Protection Industry	178 B
□ 570	Process Safety: It's Rocket Science, but it Doesn't Take a Rocket Scientist	196 C
□ 571	Implications of ANSI/ASSE Z590.3: A Prevention Through Design Standard	184 A
□ 572	Effective Training for Adult Learners	180
□ 573	Expo Education: Implementing NFPA 70E for Arc Flash Safety	184 B/C
□ 574	Spanish Session: Delivering the Safety Message Across Cultures - Llevando el Mensaje de Seguridad a Través de Culturas	175 B
□ 575	Key Issue Roundtable #2: Indoor Environmental Quality (IEQ) Issues in the Green Building Industry	176 B
6:45PM-11:00PM	100th Anniversary Gala	Navy Pier, Grand Ballroom

TUESDAY, JUNE 14

7:00AM-4:45PM	Safety 2011 Conference Registration Open	Level 3
7:30AM-9:15AM	General Session	Level 3, Skyline Ballroom
9:00AM-3:30PM	Exposition Open	Exhibit Hall F1
9:15AM-10:45AM	Exposition Exclusive Time	Exhibit Hall F1
9:30AM-10:15AM	How to Prepare a Proposal to Speak at the PDC	179 B
10:45AM-11:45AM	Concurrent Educational Sessions, Period III	Levels 1 & 2
□ 601	Depositions for Safety Professionals	194 A/B
□ 602	The Seven Skills You Must Possess To Be Your BEST!	190 A
□ 603	A Multinational Look at Building Codes	179 B

Continued on next page.

10:45AM-11:45AM	Concurrent Educational Sessions, Period III (Continued)	Levels 1 & 2
□ 604	The Safety and Health Sustainability Index: A New Measure of Organizational Commitment to Corporate Social Responsibility	196 B
□ 605	The Growing Problem in Ergonomics: Obesity	184 B/C
□ 606	Dust Explosion... Updates on NFPA 654 and OSHA Combustible Dust National Emphasis	190 B
□ 607	Wellness, an Essential Component of H,S&E Improvement and Incident Prevention	179 A
□ 608	Women in Safety: Gender Issues and Challenges Over the Years	178 A
□ 609	Change Anything: The New Science of Personal Success	186
□ 610	Evolution of Health and Safety Regulation, Management and a Profession in the UK	175 C
□ 611	OSHA Small Business Update	176 A
□ 612	A Risk Management Model for the Home Health Services Industry	178 B
□ 613	How to Make Matrix Methods of Risk Analysis More Effective and Accurate	196 C
□ 614	Safety the Team Approach for Effective Leaders	196 A
□ 615	The Buried Truth Uncovered	175 A
□ 616	Where Are All the Leaders?	180
□ 617	High Performance Safety: The New Paradigm to Safety Excellence	192 A-C
□ 618	Auditing Mechanical Integrity Programs in PSM-Covered Facilities	184 D
□ 619	OSHA's Proposed Subpart D and I: What's the Big Deal?	184 A
□ 620	Wild, Wacky, and Highly Effective Training 3.0	181
□ 621	Distracted Driving: What's your Company's Policy	183 C
□ 622	Expo Education: When Is It Time to Replace Your AED?	176 C
□ 623	Fundamentals of SH&E: Hazard Identification and Control 101B	193
□ 624	Key Issue Roundtable #3: ASSE Engagement in OSHA's Establishment of an I2P2 Standard	176 B
11:45AM-1:00PM	Complimentary Conference Luncheon	Enter through Exhibit Hall F1
	Chapter Recognition Luncheon	Level 1, Room 185
	CoPS Awards Luncheon	Level 1, Room 187
1:00PM-2:00PM	Executive Summit	Level 3, Skyline Ballroom
1:00PM-3:00PM	Student Roundtable Program	Level 4, Room 474 A
2:00PM-3:00PM	Exposition Exclusive Time	Exhibit Hall F1

3:00PM-4:15PM	Concurrent Educational Sessions, Period IV	Levels 1 & 2
□ 631	Driving Performance in any Organizational Structure	183 C
□ 632	The Uninspiring Leader: 10 Fatal Flaws that Cripple Leaders' Effectiveness	181
□ 633	Generating a Safety Culture in Construction: How to Create a Safety STEP-Change	186
□ 634	Sustainable Fleet: Impact of Fleet Safety Management on Sustainability Goals	179 A
□ 635	Ergonomics Assessments: Optimizing the Team Approach	196 A
□ 636	Footwear Characteristics and Potential Implications on Worker Safety	176 C
□ 637	Human Vibration	175 A
□ 638	NIOSH Guidelines for Preventing Exposures to Hazardous Drugs	179 B
□ 639	Fall Protection: Yesterday, Today and Tomorrow	196 C
□ 640	Complacency, The Silent Killer	190 A
□ 641	Contractors in Contingency Operations: Supporting Operation Enduring Freedom	176 A
□ 642	Does Your Personal Protective Equipment Protect You?	193
□ 643	Communicating During a Crisis: A Case Study of the BP Oil Spill	194 A/B
□ 644	Safety on the Road: Risk-Based Management of Non-Regulated Fleets	180
□ 645	Building Your Safety Culture: Practical Applications	192 A-C
□ 646	Corrective Action Review Boards in Safety	178 A
□ 647	The Power of Safety and Health Management Systems	190 B
□ 648	ANSI / ASSE A10 Standards: Their Use and Implementation on Construction and Demolition Sites	184 D
□ 649	7 Keys to Preventing Slips, Trips, and Falls	196 B
□ 650	Tips for Effective E-Learning	184 B/C
□ 651	Expo Education: Flame Resistant Work Apparel: Past / Present / Future	178 B
□ 652	Fundamentals of SH&E: Fire Protection 101C	184 A
□ 653	Key Issue Roundtable #4: Preparing for Plant Openings/ Post-Recession/Expansion	176 B
4:30PM-5:30PM	Concurrent Educational Sessions, Period V	Levels 1 & 2
□ 661	How to Promote the Business Value of EHS	190 A
□ 662	Lessons from Past ASSE Presidents and Fellows	178 B

Continued on next page.

4:30PM-5:30PM

**Concurrent Educational Sessions,
Period V (Continued)**

Levels 1 & 2

□ 663	Project Safety: Starting and Sustaining a Strong Process	179 A
□ 664	Corporate Social Responsibility: An International Perspective	183 C
□ 665	Biosafety and Biosecurity: Regulations To Protect Dual Use Technology	175 A
□ 666	The Restoration industry: An Important Ally for Safety & Health Professionals	175 C
□ 667	The Crosshairs: When Do You Really Need an IH Assessment and By Whom?	186
□ 668	U. S. Construction Safety: Heritage, Current Practice and Future Innovation	179 B
□ 669	Got Battery Cables? When BBS Goes On Life Support...	193
□ 670	Winning the Hearts and Minds of Workers in a Foreign Culture for SHE Success	184 A
□ 671	Meet the Inspectors	178 A
□ 672	Conducting Health & Safety Audits that Protect Employees & Business	192 A-C
□ 673	Concept of Dynamic Risk Assessment: Does it Apply Everywhere?	194 A/B
□ 674	Safe by Accident?: Safety Practices that Take the Luck out of Safety	181
□ 675	Building a Desired Safety Culture: Controlling Loss Producing Variability	184 B/C
□ 676	Overcoming Organizational Barriers to Safety and Health Excellence	196 B
□ 677	Incentives in Safety: Considerations for Leaders	190 B
□ 678	OSHA, Construction and Industry Working Ever Closer Together on Fall Protection	184 D
□ 679	Electrical Safety for Your Other Employees	196 C
□ 680	Standards Forum: The Use of National Voluntary Consensus Standards for SH&E	176 A
□ 681	Safety, Seguridad, Sécurité: Training a Multicultural Workforce	175 B
□ 682	What's the Tweet? Distracted Driving Myths, Reality and Corporate Liability	180
□ 683	Expo Education: Sprains & Strains: The Silver Bullet!	196 A
□ 684	Forecasting Nano Law: Risk Management Protecting Public Health	176 C
□ 685	Key Issue Roundtable #5: Combustible Dust Discussion Forum	176 B

WEDNESDAY, JUNE 15

7:00AM-3:15PM	Safety 2011 Registration Open	Level 3
	Post-Conference Seminars Registration Open	Level 3
7:45AM-11:45AM	Academic Forum	Hyatt Regency Chicago, Acapulco Room
7:45AM-9:00AM	Concurrent Educational Sessions, Period VI	Levels 1 & 2
□ 701	Pipelines and Grids: Tools from Executive Coaching for Safety Leaders	178 A
□ 702	Sky High? Challenges and Opportunities for EH&S Professionals in the Next Decade	194 A/B
□ 703	The Silver Bullet: U.S. Army Corps of Engineers EM385-1-1 Construction Standard	179 A
□ 704	Achieving Safety Excellence in Construction: Beyond Compliance	196 C
□ 705	Responding to Emergencies, First Considerations	184 B/C
□ 706	Controlling Occupational Exposures to Historically Hazardous Materials	184 A
□ 707	ERGO Breaks & Power Zone Training: Low Cost Ergonomics Solutions	196 A
□ 708	Hot Work Programs and the Human Factor	180
□ 709	Radiation and Silica Risks to Granite Countertop Workers	176 C
□ 710	International Forum	176 A
□ 711	OSHA's VPP Continues to Bring Value	183 C
□ 712	Integrating Your Approach to Safety and Claims Management	186
□ 713	Risk Based Safety Leadership: Safety for the Next 100 Years	192 A-C
□ 714	The Layered Approach to Hazard Recognition	190 A
□ 715	Managing System Driven Incidents: A Holistic Approach	178 B
□ 716	Supervisor? You've Got to Be Kidding!	196 B
□ 717	Lessons from Disasters: Trends in Major Safety Incidents Around the World	190 B
□ 718	Performing Arc Flash Hazard Analysis on Wind Farms	175 A
□ 719	Delivering Safety at Height in the Workplace	193 A
□ 720	Bag of Tricks: Presentation Design	181
□ 721	Motor Vehicle Crash Analysis: Obtaining Honest Answers About Vehicle Collisions	184 D
□ 722	Expo Education: Smart Safety Design to Prevent Slips, Trips and Falls	179 B
□ 723	Fundamentals of SH&E: Workplace Health 101D	175 C

Continued on page 10.



LEVEL 1

Concurrent Sessions
W175 – W196

LEVEL 2

Hyatt Meeting Rooms
21 – 24

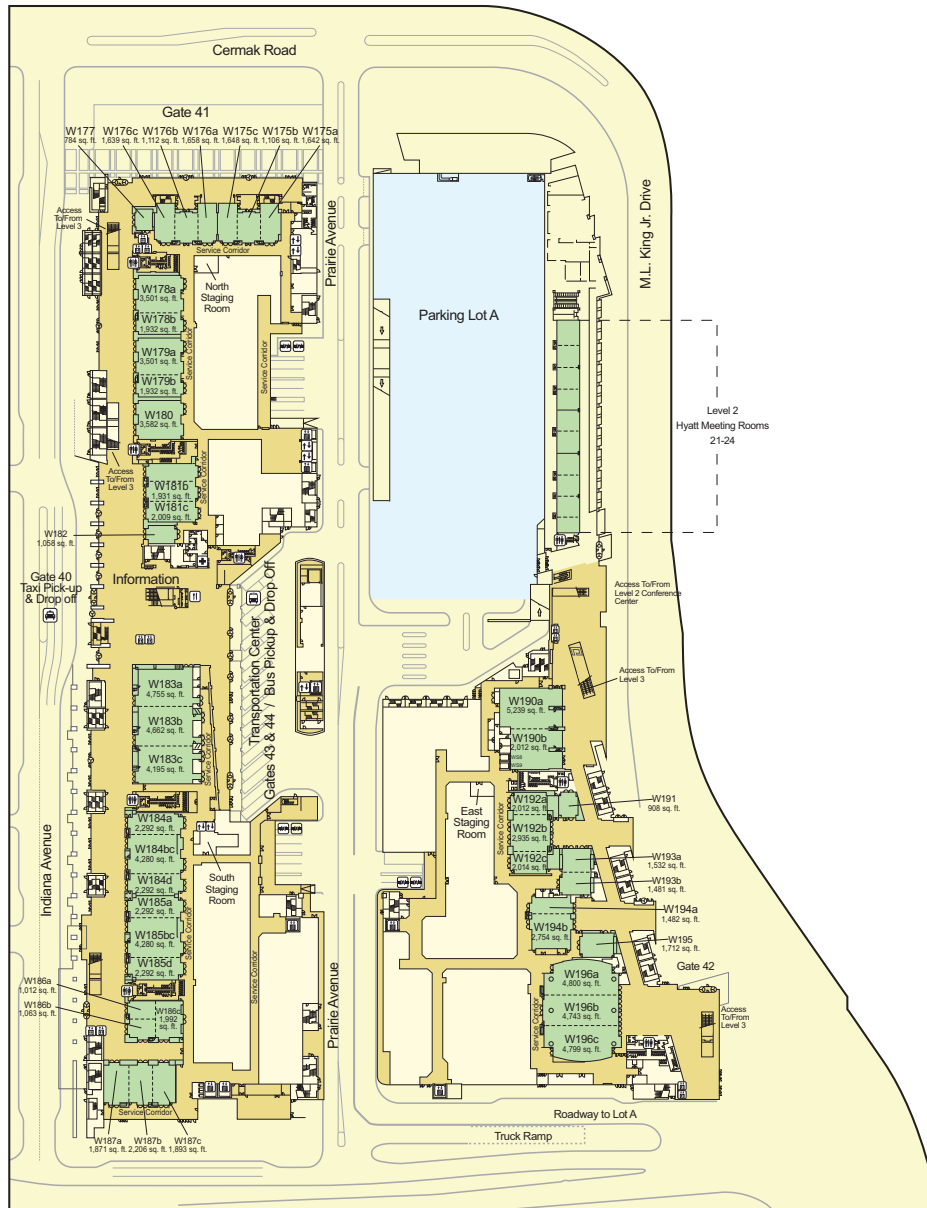



LEVEL 3

- General Session
- Executive Summit Panel
- Lunches
- Exposition
- Service Center
- Registration

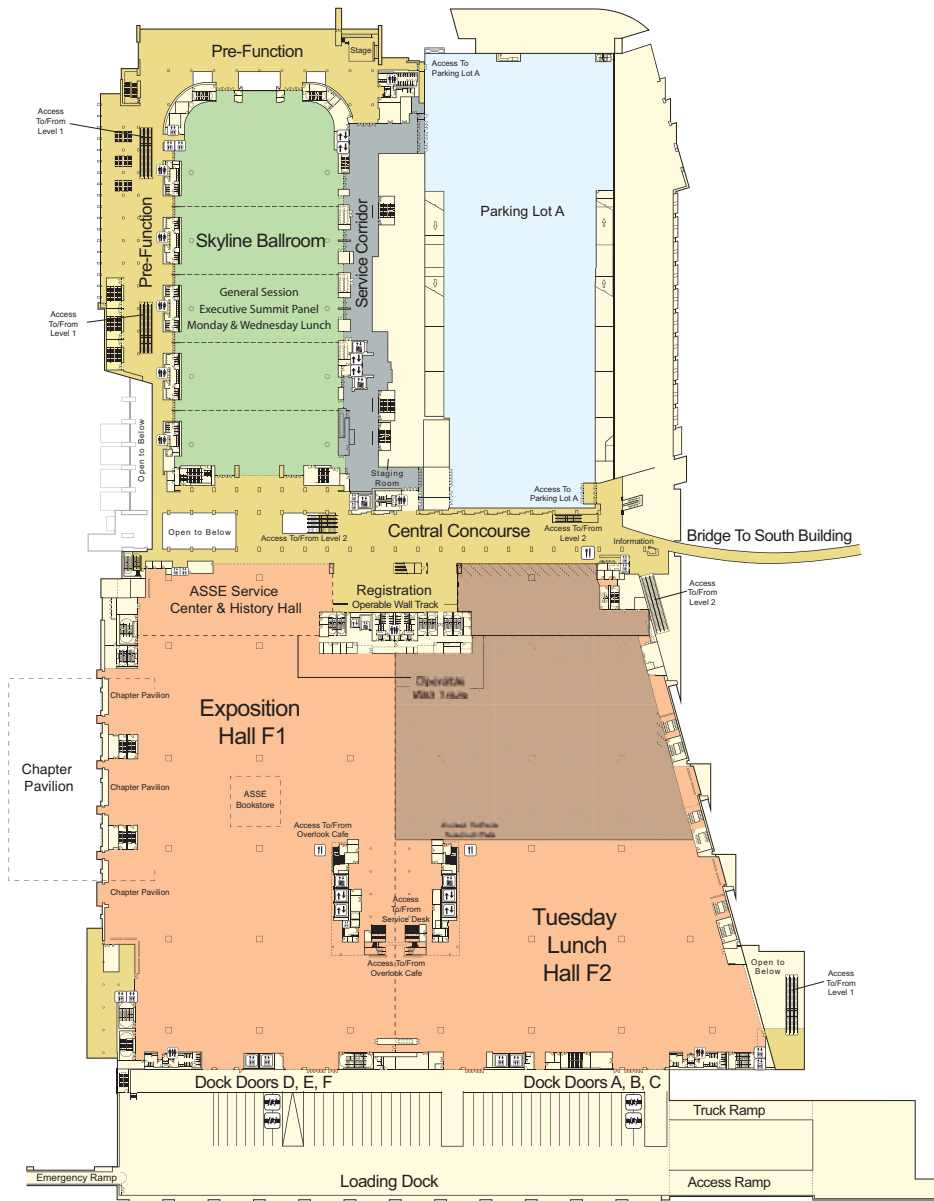

7:45AM-9:00AM Concurrent Educational Sessions, Period VI (Continued) Levels 1 & 2

- 724 Key Issue Roundtable #6: What is the Role of Environmental Management in a Safety Organization? 191
- 725 Key Issue Roundtable #7: Safe Patient Handling 176 B

9:15AM-10:30AM Concurrent Educational Sessions, Period VII Levels 1 & 2

- 726 Business Lessons for the SH&E Manager: The Difference Maker 183 C
- 727 Selling Safety by Selling Yourself 196 B
- 728 Meeting New Legislative and Regulatory Challenges for MSHA Compliance 175 A
- 729 OSHA Construction & General Industry Standards: Important Differences 190 B
- 730 Disaster Psychology: Dispelling the Myths of Panic 176 A
- 731 Auditing Your Ergonomic Process: Ensuring Success and Sustainability 180
- 732 Fire Protection Systems: An Important Part of Employee Safety 184 A
- 733 Improving Hearing Conservation Practice with Fit Testing 184 D
- 734 Confined Space Atmospheric Test Instruments and Their Limitations 196 A
- 735 Safe Resident Transfer in the Assisted Living Environment 178 B
- 736 A Beginners Guide to Accident Reporting Outside of the United States 176 C
- 737 Incentive Programs and Their Effect on OSHA, VPP, and Recordkeeping 196 C
- 738 Experience Modification Rates: Are They an Accurate Measure of Safety? 194 A/B
- 739 Loss Control Executive Summit 186
- 740 A Transformational Safety Journey 178 A
- 741 The Thirteen Safety Functions of a Good Supervisor 190 A
- 742 Near Miss Reporting: The Missing Link of Safety Culture Revolution 181
- 743 Safety Leadership: The Final Hurdle Toward Zero 192 A-C
- 744 BioEngineering Analysis of Design Disparities and Female Injury Rates 175 C
- 745 What's New in the ANSI Fall Protection Code, Hazard Analysis and Rescue Planning 184 B/C
- 746 The Nano Label: Developments and Potential Human Factor Issues 193 A
- 747 Advancing Your Safety Career with Online Education 179 A

□ 748	Expo Education: Is Your OSHA Inspector Looking for NFPA 2112 Compliance?	175 B
□ 749	Fundamentals of SH&E: Environment 101E	179 B
□ 750	Key Issue Roundtable #8: Impact of CSA 2010	176 B
11:00AM-12:00PM	Concurrent Educational Sessions, Period VIII	Levels 1, 2 & 4
□ 751	Showing EHS Value Through Return On Investment (ROI)	192 A-C
□ 752	Construction Safety Forum	186
□ 753	Implementing a CSR Process: A Natural Evolution of SH&E Excellence & Culture	184 A
□ 754	Influence of Different Insoles on Balance, Performance and Leg Muscle Activity	176 A
□ 755	The Fire Prevention Plan, Another Type of Hazard Analysis	179 A
□ 756	Fit for Duty Functional Testing for New Hires and Return to Work	181
□ 757	200 Years of ASSE	179 B
□ 758	Neuroleadership: Transforming Safety by Improving Thinking	196 C
□ 759	Safety and Health Resources for Diverse Workforces	178 B
□ 760	ASSE Government Affairs Committee Update	175 A
□ 761	GHS – It's Coming Sooner than You May Think... Are You Prepared?	184 B/C
□ 762	Prioritizing Risks: A Cost Benefit Approach	190 B
□ 763	Workers' Compensation for Supervisors & Managers	180
□ 764	Actions Speak Louder Than Words: A Positive Approach to Workplace Safety	190 A
□ 765	Occupational Dog Bite Prevention: Helping to Protect Employees from Dog Attacks!	471 A
□ 766	Four Components to a Safety Program that Works!	196 B
□ 767	Safety in the Bizarro World	194 A/B
□ 768	Identifying Confined Spaces	183 C
□ 769	Natural Gas Piping & Purging: 10 Hazards and How to Avoid Them	193 A
□ 770	Using Fall Protection Procedures in the Real World	196 A
□ 771	Hands-on Training: There is Time, Even if Operations Does Not Know	178 A
□ 772	Trucking Industry Benchmarks and Best Practices	184 D
□ 773	Expo Education: Proposed Amendments to the Toxic Substances Control Act (TSCA)	176 C

Continued on next page.

11:00AM-12:00PM Concurrent Educational Sessions, Period VIII (Continued) Levels 1, 2 & 4

□ 774 Spanish Session: Reducing Falls and Silica Exposure in the Construction Industry – Preliminary Lessons Learned – Reduciendo las Caídas y la Exposición a Sílice en la Industria de la Construcción – Preliminares Lecciones Aprendidas 175 B

□ 775 Key Issue Roundtable #9: Product Stewardship and Supply Chain Safety 176 B

12:00PM-1:30PM Conference Luncheon & Program Level 3, Skyline Ballroom

1:45PM-3:00PM Concurrent Educational Sessions, Period IX Levels 1 & 2

□ 776 Safety Ethics: Who Comes First the Employer or The Employees? 194 A/B

□ 777 If You Can Manage an All Volunteer Organization, You Can Manage Your Own 184 A

□ 778 Building Safety Culture with Latino and Non-Latino Construction Workers 176 C

□ 779 Interventions for Overhead and Concrete Drilling 175 A

□ 780 Failure to Rescue = Confined Space Fatalities 180

□ 781 Lithium Batteries: What Every SH&E Manager Must Know 178 A

□ 782 Welding and Industrial Hygiene: The Science of the Welding Process 196 B

□ 783 Beat the Heat: A Guide for an Effective Heat Stress Prevention Program 183 C

□ 784 Keeping People Safe: The Human Dynamics of Injury Prevention 181

□ 785 2011 Global Safety and Health Briefing 196 C

□ 786 Defeating the Trump Card: Legal Limits on OSHA's Use of the General Duty Clause 184 B/C

□ 787 The Electrical Transmission & Distribution OSHA Partnership: Focusing on Safety and Health 178 B

□ 788 Managing Contractors in a General Industry Environment 196 A

□ 789 Early Return-to-Work: Benefits, Best Practices and Barriers 184 D

□ 790 Achieving an All Employee 100% Committed Safety Culture 192 A-C

□ 791 Special Needs Employees: Same Pay – Same Work – Safety Excellence 175 C

□ 792 STEPS (Strategic Targets for Excellent Performance in Safety) 190 B

□ 793 Human Reliability Analysis: Cardiac Hospital Case Study with New Applicability 176 A

□ 794 Safety Engineering and the Design Review Process: Prevention through Design 190 A

□ 795	Dice, Crayons and Taboo: Bringing the Life Back to Safety	186
□ 796	Using ANSI/ASSE Z15.1 as the Foundation for Fleet Safety Program Evaluations	193 A
□ 797	Expo Education: Current Fall Protection Technology Makes Incorporating Rescue Easier and More Cost Effective	179 B
□ 798	Fundamentals of SH&E: Risk Management 101F	179 A
□ 799	Key Issue Roundtable #10: Flame Resistant Clothing Update	176 B
□ 7990	Key Issue Roundtable #11: Public School Safety	191
2:00PM-6:00PM	Post-Conference Seminar	
□ 801	Half-Day Math Review	Hyatt Regency, CC21
3:15PM-4:15PM	Concurrent Educational Sessions, Period X	Levels 1, 2 & 4
□ 7010	Advancing Your Career: From Safety Manager to Business Partner	190 A
□ 7020	Confined Space in Construction	194 A/B
□ 7030	A Decade Since Columbine: What We Learned, What We Did, and What We Need To Do	178 A
□ 7040	Green and Safe: Why not Both?	196 C
□ 7050	Patient Care Ergonomics: Biomechanical Drivers for Patient Handling Technology	193 A
□ 7070	Food at Rest is Food at Risk	178 B
□ 7080	Engagement: Does it Really Matter?	192 A-C
□ 7090	The Future of OSH Education in the Gulf	176 C
□ 7100	Public Employers: Is This YOUR Work Zone?	175 A
□ 7110	Emerging Issue in Safety Management and Coordination of Risk Control Services for Owner Controlled Insurance Programs (OCIPs)	180
□ 7120	Aligning Risk Assessment & Risk Mitigation Methodology with Business Processes	190 B
□ 7130	Contractor Safety 102: Formulas and Real Time Snapshots	183 C
□ 7140	Increasing Hazard Reporting with a Just Safety Culture	196 A
□ 7150	Told Employee to Pay Attention: How is Your Investigation Process Performing?	196 B
□ 7160	Determination of Weighting Factors in the Improvement of Incident Rate Analysis	186
□ 7170	NORA2, and the Manufacturing Research Agenda	176 A
□ 7180	Fall Protection or Base Jumping: Vertical Lifelines on the Job Site	184 D
□ 7190	Electrical Safety on Multi-Employer Worksites	184 B/C

Continued on next page.

3:15PM-4:15PM

**Concurrent Educational Sessions,
Period X (Continued)**

Levels 1, 2 & 4

□ 7200	Scanning for Safety: How to Really See and Recognize Health and Safety Hazards	181
□ 7210	Expo Education: Layers of Protection: Minimizing the Impact of Combustible Dust	175 B
□ 7220	Fundamentals of SH&E: Basic Safety Management 101G	184 A
□ 7230	Key Issue Roundtable #12: The New OSHA Crane and Derrick Standard	470 B
□ 7240	Key Issue Roundtable #13: Changes in Manufacturing in Industries Affected by the Economic Downturn	176 B

ASSE thanks the following organizations for their sponsorship.

CENTENNIAL SPONSORS



GOLD SPONSORS



SILVER SPONSORS



BRONZE SPONSOR



Safety Products

SOCIETY SPONSORS



The Safety Company

EXPOSITION SPONSOR



ASSOCIATE SPONSORS

3E Company
Alchemy Systems
Alliant Corporation
All-Star Incentive Marketing
American Heart Association
Aon Corporation
Aramark Uniform Services
Bowen EHS
Bureau Veritas
Gateway Safety, Inc.
Glen Raven Tech Fabrics
Glove Guard

Guardian Equipment
HeatTrak
LJB, Inc.
MEGACOMFORT
NJ & Associates
Pekron Consulting
Primary Source
Red Wing Brands of America
Reliance Fall Protection
Remedy Interactive
SiteHawk
SlipNOT Metal Safety Flooring

POST CONFERENCE SEMINARS

THURSDAY, JUNE 16 – SATURDAY, JUNE 19

7:00AM-7:45AM	Post-Conference Seminars Registration Open	Outside 193 A
8:00AM-4:30PM	Post-Conference Seminars	Hyatt Regency McCormick (HRM) and McCormick Place West Convention Center

THURSDAY, JUNE 16

One-Day Seminars

□ 810	Investigative Photography	CC24b/c
□ 811	Managing Contractor Safety: Implementing an Effective Contractor Safety Program	CC20a/b
□ 812	Techniques for Overcoming Organizational Barriers to Achieve Safety Success	CC22c
□ 813	Coaching to Improve Safety and Health Performance	CC22a/b
□ 814	Fatality Prevention: Issues and Possible Solutions	CC21c
□ 815	Systematic Slip, Trip and Fall Prevention: Strategies that Work!	CC23
□ 816	Integrating Safety Into Your Organization's Strategic Plan	CC21a/b
□ 818	Advanced Fire Prevention	196 A
□ 819	Culture Change: A Diagnostic and Action-Planning Framework	196 B

THURSDAY & FRIDAY, JUNE 16 & 17

Two-Day Seminars

□ 821	Safety Management II	190 A
□ 822	Incident Investigation and Root Cause Analysis	190 B
□ 823	Industrial Hygiene for the Safety Professional	193 A
□ 824	Basic Electrical Safety with Application of NFPA 70E	194 A
□ 825	Principles of Leadership	CC24a

THURSDAY – SATURDAY, JUNE 16-18

Three-Day Seminars

□ 831	ASP Exam Preparation Workshop	192 C
□ 832	OHST Exam Preparation Workshop	192 A
□ 833	Managing the Business Aspects of Safety	192 B

FRIDAY, JUNE 17

One-Day Seminars

□ 911	Occupational Risk Assessment Strategies	CC24b/c
□ 913	Managing an Ergonomics Program	CC20c
□ 915	Creating Safety Training Programs That Work	CC21a/b
□ 916	Risk-Based Budgeting and Calculating ROI	CC21c